

# LD60



Miniature LED Uplight and Wall Light

Data sheet



Design: Brilliant Lighting Project: Private residence Product: LD60

LD60 is a very tough, compact fitting with a larger bezel than the LD41. It can be run up to 1.7W, and comes with a choice of beam angles making it suitable for a wide range of applications.

## Key Features

- Larger bezel to hide damage that might be caused to the delicate surrounding surfaces when drilling hole cut-out
- Can be specified with frosted glass for indicator applications, a wide beam works best for this effect
- Machined from a solid billet of stainless steel 316
- No visible fixings. Fixing options include O-rings and a first fix sleeve or bonding directly into the mounting surface
- Integral anti-wicking barrier increases protection against moisture ingress due to incorrect IP rated cable connections
- Not designed for permanent submersion, please use our LD242A
- Available with Switch, 0-10V, DMX, Dali or Mains dimmable drivers



## Specification

Applications				
Beam Angles	12°, 31°, 48°, 36° x 12°			
LED type	1 x Cree XPG2			
Colour temperature	2700K** / 3000K		5000K	
Drive Current (mA)	350	500	350	500
LED power* (W)	1.2W	1.7W	1.2W	1.7W
CRI (typical)	93	93	75	75
Forward voltage (V) <sub>100</sub>	3.0V	3.2V	3.0V	3.2V
Delivered lumens** (L <sub>100</sub> )	88	120	107	146
Lumens per circuit watt	73	71	89	86
LED lifetime (to 70% lumen maintenance)	50,000hrs at a max ambient temperature of 35°C (if specifying fitting in ambient temperatures of up to 45°C run at 350mA max, LD60-350)			
Materials	Machine finish 316 stainless steel			
Glass	5mm thick borosilicate			
Wiring	Comes pre-wired with 2 core 100mm lead, can be specified with up to 10m at extra cost			
IP rating	IP68 - Not for permanent submersion (for permanent submersion applications use LD242A)			

\*LED wattage includes losses associated with using an 85% efficient driver

\*\*2700K lumen output is 12% lower than the 3000K figure listed

4000K lumen output is 14% higher than the 3000K figure listed (80 CRI)

# LD60



Miniature LED Uplight and Wall Light

Data sheet

## Dimensions and Fixing Options

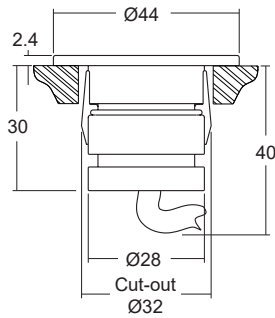
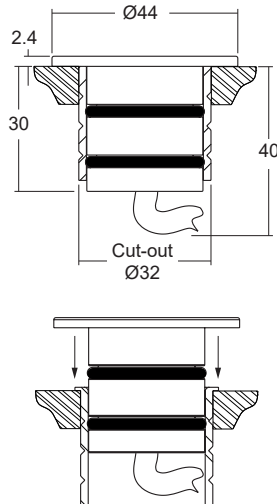
**/SC** - Spring clips

**/480** - O-rings and sleeve

(Dimensions in mm)

**/480GT** - Ground tube

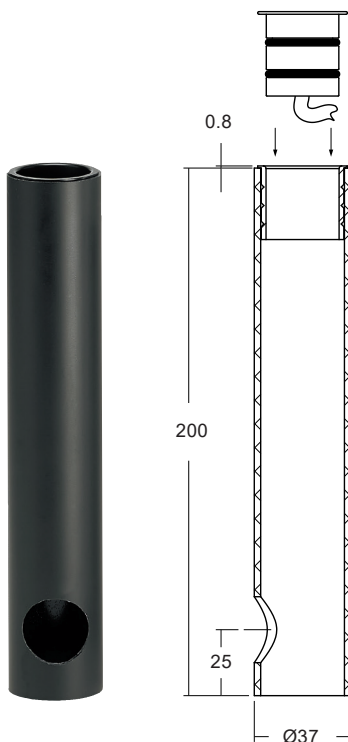
The in-ground tube has been designed for applications where a recessed uplighter is required in soil or gravel surfaces. The tube can be buried with the necessary wiring, and then the fitting installed after the landscaping work has been completed. It is supplied with the fixing sleeve bonded into the tube, and can be cut down on site.



## Photometrics

Photometric files are included in the design pack which can be downloaded from the LD60 product page on the website.

## Order Codes and Options

Product code	LED colour	Lens angle	Finish	Fixing
LD60 - 350 - 500				

Example: LD60-500 / LW30 / MB / Stainless steel / 480

### Product codes with output option

1.2W LED at 350mA	<b>LD60-350</b>
1.7W LED at 500mA	<b>LD60-500</b>

### LED colour options

LED colour options	Suffix
Super Warm White (2200K)	/LW22
Extra warm white (2700K)	/LW27
Warm white (3000K)	/LW30
White (4000K) - on request	/LW40
Cool white (5000K)	/LW50
Blue	/LB
Green	/LG
Red	/LR
Amber	/LA

\*Other LED colour temperatures are available. Please speak to a member of our sales team.

### Beam / lens angle options

12° narrow spot	/NB
31° medium	/MB
48° wide	/WB
36° x 12° oval	/OB

### Bezel finish options

Stainless steel (standard)  
 Polished stainless steel (passivate for marine / underwater environments)  
 Paint finish white / black / RAL (see finishes guide for suitable applications)

### Fixing options

First fix sleeve and O-rings	/480
Ground tube	/480GT
Spring Clips	/SC

### Use with 350mA and 500mA constant current LED drivers

We have a wide range of dimmable LED drivers, 1-10V, DMX, DALI and Mains dimmable. Please see the downloads section on our website:

To run 1-14 LD60-350 in series use a TXDEL350D (0-10V dimmable)

To run 1-14 LD60-500 in series use a TXDEL500D (0-10V dimmable)